

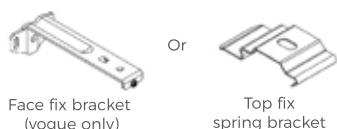

**DO NOT OPEN
PACKAGE WITH
A KNIFE**

YOU SHOULD HAVE



BRACKETS



ALUMINIUM WAND

ITEMS REQUIRED



SCREWS REQUIRED

Please use the correct screw type for your wall/surface



TOOLS REQUIRED

- Screwdriver
- Drill
- Tape measure
- Pencil

FITTING THE BRACKETS

You will have at least two separate boxes. One containing the headrail and one containing the fabric vanes. Carefully unwrap the Allusion headrail and its associated brackets. The brackets that you selected when placing the order will either be face fix screw or top fix spring.

The brackets should be located to allow for the depth of the vanes to tilt. Vogue top fix requires 90mm space to the rear, 80mm Fascia top fix requires 110mm space to the rear. (from the centre of the bracket). If using face fix brackets no allowance is required.

The brackets should therefore be attached to the ceiling or window frame clear from any obstruction and it's important they are in-line with each other.

For a blind up to 900mm wide attach two brackets fitted approximately 40mm (1½") from each end of the blind. On wider blinds any intermediate brackets should be spaced evenly between these, and as a general rule dependant on how well the brackets are fitted, use the following as a guide:

- Up to 900mm = 2 brackets.
- 900mm to 1600mm = 3 brackets.
- 1600mm to 2300mm = 4 brackets.
- 2300mm to 3000mm = 5 brackets.
- 3000mm to 3700mm = 6 brackets.

Mark the bracket hole positions before drilling and plugging if necessary. Use two screws for a face fix bracket and one screw in a top fix bracket ensuring that the brackets are level. Remember to allow room for the blind to clear any obstacles when deployed, e.g. door or window handles.

RECESS INSTALLATION

For Recess installation use the larger hole in the bracket for fitting, as this hole will allow for small adjustments afterwards.

1. Place one bracket inside the recess, where you intend to fit it. The drill hole must be at least 90mm away from the window for Vogue and 110mm away for the Fascia. The first and last brackets are to be 70mm away from the edge of the side walls. Distribute all other brackets evenly.
2. Hold the first bracket tight and mark through the large hole with a pencil.
3. Remove the bracket & measure the distance from the window to the pencil mark. Use this measurement to mark out the rest of the holes required.
4. Drill and plug the screw hole marks with suitable fixings and screw in to place.
5. All the bracket fronts should be the exact same distance from the window. If you need to make slight adjustments, loosen the screw and slide the bracket back or forth, so that the brackets are all perfectly aligned (within a 1mm tolerance).

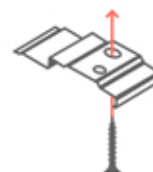
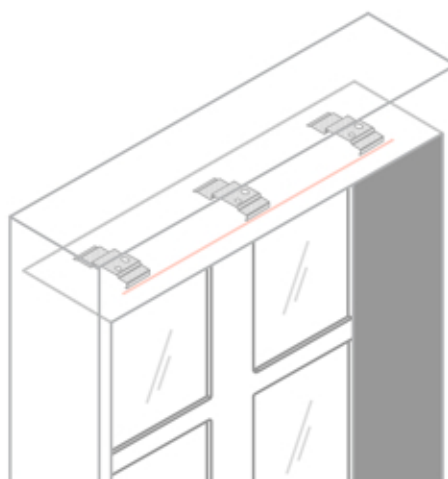

FACE FIX INSTALLATION

1. For face fix installation, if you are mounting on a wall you will have to do a little bit of math.
If you ordered Recess size, then use the drop of your blind + 5mm, this will allow a distance between the bottom of your fabric vanes and the floor of approx 10mm. increase the +5mm if you want a larger gap.
If you ordered Exact size then use your drop +15mm, again you can increase this if required.
Once you have this size, measure from the floor, up the wall central to where you intend to fit the blind, up to the size calculated.
2. Mark the wall with a small pencil mark.
3. Take a face fix bracket and hold it up against the pencil mark so that the top of the bracket is level with the mark.
4. If you are happy with this positioning, hold the bracket firmly in place and mark through the 3 holes.
5. Evenly mark up all other brackets in the same way, insuring that the end brackets are around 70mm inside the edge.
6. Before drilling the holes, try holding a straight edge or spirit level up against the marks to make sure they are horizontally aligned and level.
7. Drill and plug the screw hole marks with suitable fixings and screw in to place.
8. All the bracket tops should be the exact same distance from a level surface.

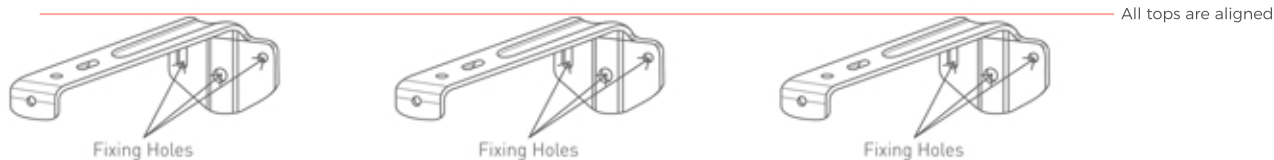

FITTING A VOGUE HEADRAIL - FACE FIX

Locate the front of the headrail by keeping the operating controls on the side of the blind as ordered (LH/RH gather) or If you have dual wands, take a look at the sliding truck hooks underneath the headrail, these are slightly offset towards the front.

If using face fix screw brackets, hook the rear lip of the headrail on to the rear hook of the brackets
if you cant hook them all on at once, just hook the centre ones on first. Now tilt the front of the blind upwards until the headrail is sitting level on the brackets. Tighten the securing screws, starting with the centre brackets and work out to the others.
Do not over tighten these screws, it is unnecessary and may damage the track.

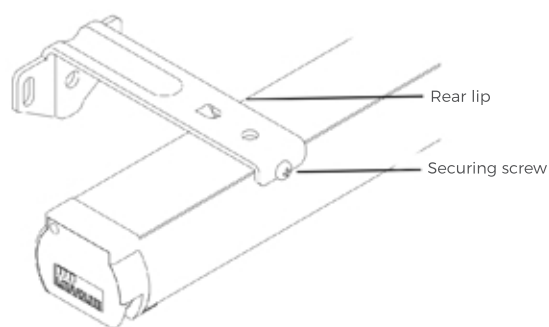
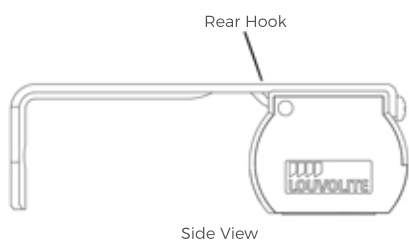

FITTING A VOGUE HEADRAIL - TOP FIX

If using top fix spring clip brackets, locate the front of the blind. Tilt the top away from you and hook the front groove of the headrail on to the front lip of the brackets. Tilt the headrail back level and push upwards on the rear of the track directly below the fitted brackets, the track will click into place.

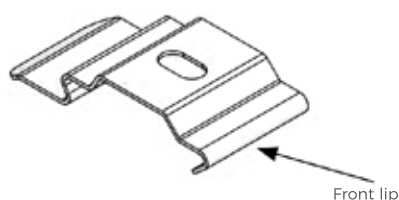

80MM FASCIA ATTACHMENT

The fascia brackets are designed to be concealed. We suggest you test fit the brackets to the cassette before fitting to your surface. This is to get a feel for how they attach.

See the diagram for the correct orientation of the brackets, the front lip faces in towards the room. For blinds over 1 metre wide, we recommend you fit a bracket roughly every 500mm.

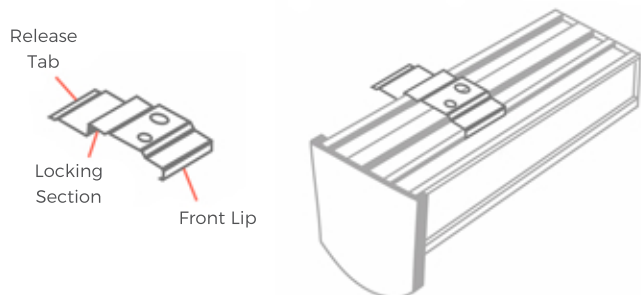

1: Tilt the rear of the Fascia down Hook the front lip of the bracket over the correct part of the fascia (see diagram).

2: Push up the rear of the fascia into the locking section of the bracket, this sometimes requires a fair bit of pressure.

3: You will hear a 'click' once it has been correctly located. If you have a wide blind and are fitting it on your own, click the centre bracket in first.

REMOVING THE HEADRAIL

Before removing a track first take down all the fabric vanes from the headrail. On all bracket types, release the edge brackets first and work your way towards the centre.

For face fix brackets, undo the retaining screw on the front to release the headrail.

For top fix brackets you have to apply upwards pressure to the release tab on the rear of the bracket.

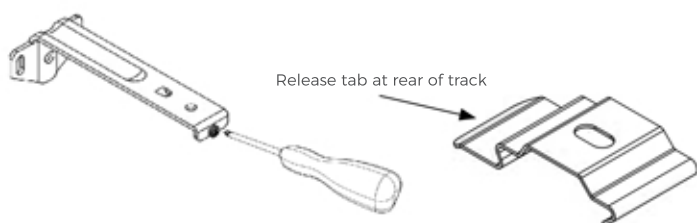

OPERATING THE BLIND

Once you have attached the wands, the blind is very simple to operate. Just sweep the wand from left to right to move the vanes. To alter the privacy and turn the vanes, just twist the wand clockwise/anti-clockwise to suit your needs.

FITTING THE FABRIC VANES

Turn the hooks on the carriers of the headrail (using the wand), so that the hooks are at 90 degrees to the track. Depending on the width of your blind you may have several bags of vanes. They will be numbered. Start by opening bag 1 and you will see one vane is marked 'left'. This is your first vane. Hang the first vane.

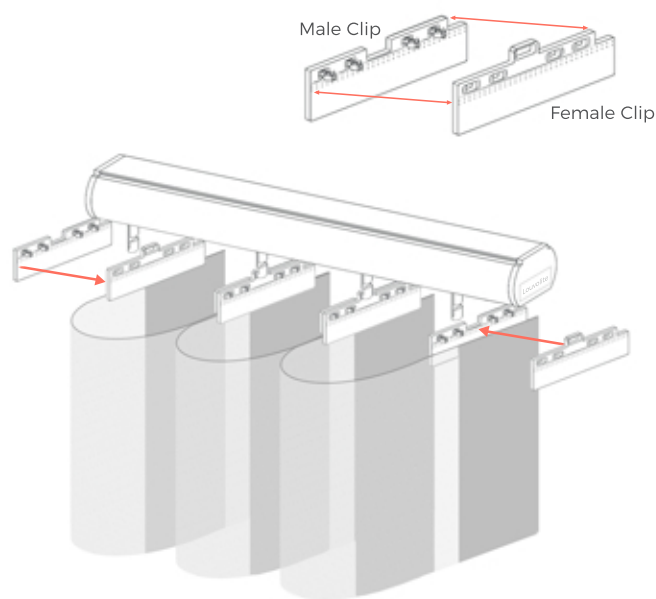

Then fit the other half of the louvre to the next carrier. Take the next vane and snap fix the non hole insert to the holed insert on the track, repeat until you get to the last carrier/louvre. When you get to the last louvre snap fix a non holed insert to the end louvre and fasten to the track. If the blind has a split draw then repeat for the other side of the blind ensuring that the seams are all facing the same direction.

FITTING THE CONTROL WANDS

You will either have 1 or 2 wands, but they fit in the same way. Angle the wand slightly and clip on the very end traveller on the headrail. Hook the end of the wand in to the hole, it may take a little pressure. Be careful not to snap these parts by using too much force.

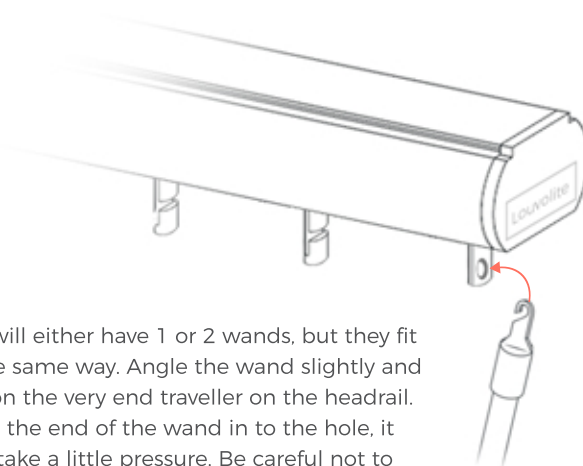



Due to the wide diversity of wall or partition types, we cannot provide you with suitable attachment fixtures. Here are some examples of attachment fixtures recommended for different wall types.



BLIND WALLS (Brick or Concrete)

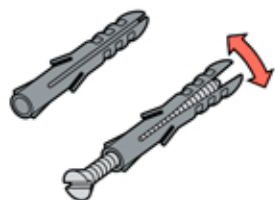
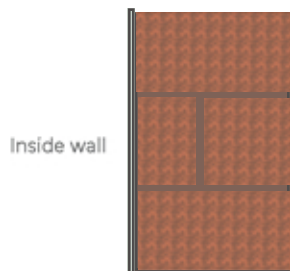

UNIVERSAL WALL PLUGS

The classical nylon wall plug is available in different basic types. When you tighten the screw the wall plug expands, so it anchors itself firmly in the wall. Drill the hole with a hammer drill and tap the plug gently into place. Then you can fit the screw. Make sure you use a type of screw that is suitable for use with wall plugs, and that has the right length and thickness for the wall plug you're using.

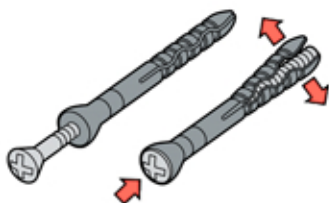

HAMMER FIXINGS

These wall plugs contain a steel nail or special screw which is driven into place in the plug with a hammer. This is a lot faster than using a conventional screw, and is ideal for fitting plinths, wooden beams, window frames, ceiling panels and wall cladding. If necessary you can tighten the screw with a screwdriver after driving it into place.

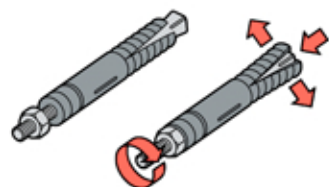

ANCHOR BOLTS

These wall plugs are intended for fixings that have to support heavy loads such as large shelves or racks. An M12 anchor bolt can usually support a load of up to 200 kg. When the nut or hook is tightened, the conical anchor is pulled inwards. The resulting pressure causes the metal segments to expand and press strongly against the surrounding material.

STUDDED WALLS (Hollow or Plasterboard)

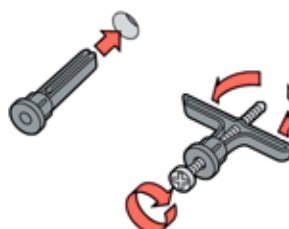
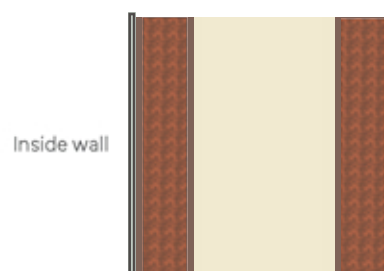

BUTTERFLY WALL PLUGS

These nylon wall plugs are intended for use in hollow walls and consist of 2 sections. When the screw is tightened, the back part of the plug is folded double towards the front of the plug. Another variant is the butterfly plug. This has 4 'wings', and is ideal for mounting in shallow holes. You can use these wall plugs for hanging paintings, light mirrors and other light items. This kind of plug gives a strong grip in plasterboard and similar materials.

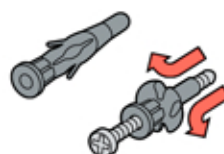

PLASTERBOARD PLUG

This plug forms a thicker section inside or behind a hollow wall. When a screw is inserted and tightened the segments expand and fold out like an umbrella. These plugs can be used with different kinds of panels, and are also suitable for mounting light items on ceilings.

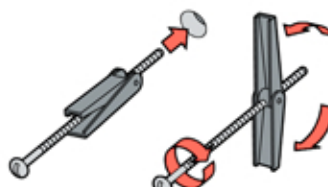

TOGGLE PLUG

Toggle plugs are mainly used in ceilings and hollow walls. They have spring-loaded 'wings' mounted on a screw thread. The plug is pushed through the hole with the wings closed and these then spread out when they are released and the screw is tightened.



Use a drill bit that is compatible in size with the hardware used and the type of wall.